

## WHYT1050 Series

## Introduction

- ROHS, Halogen Free and REACH compliance
- High rated current
- 125°C maximum total temperature operation
- 11.5×10.3×5.0mm maximum surface mount package
- Low core loss
- Ultra low buzz noise due to molding construction

## Applications

- Laptops and PCs
- Switch and servers
- Base stations
- DC/DC converters
- Battery powered devices
- SSD modules

## Product Identification

WH   YT   1050   --1R5   M  
①   ②   ③   ④   ⑤

- ① WH ----- Company Name Code
- ② YT ----- Series name
- ③ 1050 ----- Dimension
- ④ 1R5 ----- Inductance Value (1R5 = 1.5 $\mu$ H)
- ⑤ M ----- Inductance Tolerance ( M=  $\pm$  20% )

## Dimensions-mm

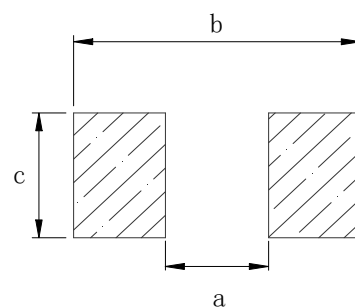
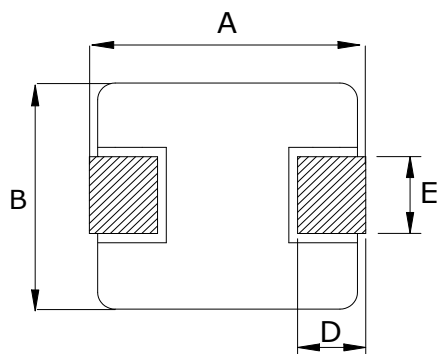

Recommend Land Pattern

A	B	C	D	E	a typ	b typ	c typ
11.5MAX	10.0 $\pm$ 0.3	4.8 $\pm$ 0.2	2.0 $\pm$ 0.5	3.0 $\pm$ 0.5	5.4	13.6	4.1



**Marking**

The inductor is marked with a 3-digit code

Nominal Inductance	
Example	Nominal Value
1R0	1.0 $\mu$ H
100	10 $\mu$ H
101	100 $\mu$ H

Note : Using Ink for marking

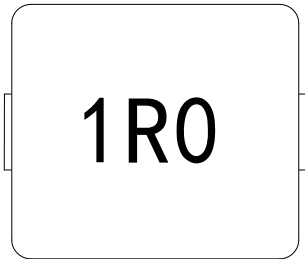

**Structure and Components**

Symbol	Components	Material
a	MARKING	Ink(black)
b	CORE	Alloy Sponge Powder
c	WIRE	Polyurethane copper wire
d	Terminal	Copper plated with Sn

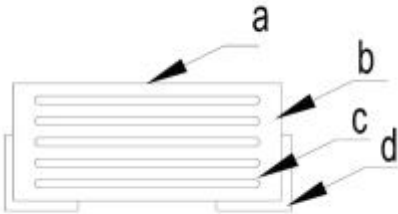

Part No.	Inductance	DC Resistance	Saturation Current	Heating Rating Current
	L0 (μH)	DCR (mΩ)	Isat (A)	Irms (A)
	±20 %, 100 kHz, 1V	MAX.	TYP.	TYP.
WHYT1050-R22M	0.22	0.8	65	37
WHYT1050-1R0M	1.0	3	30	23
WHYT1050-1R5M	1.5	3.8	25	21
WHYT1050-2R2M	2.2	6	19	15
WHYT1050-3R3M	3.3	10	16	13
WHYT1050-4R7M	4.7	14	15	11
WHYT1050-5R6M	5.6	17	14	9.5
WHYT1050-6R8M	6.8	18.5	14	9
WHYT1050-100M	10	28	10	8
WHYT1050-150M	15	42	7.5	6.5
WHYT1050-220M	22	50	6	5.5
WHYT1050-330M	33	86	5.2	4.8
WHYT1050-470M	47	127	4.5	3.7
WHYT1050-101M	100	290	2.8	2.1

#### Notes

1. All test data is referenced to 25 °C ambient
2. Operating temperature range - 55 °C to + 125 °C
3. Irms (A):DC current (A) that will cause an approximate ΔT of 40 °C(reference ambient temperature is 25 °C)
4. Isat(A):DC current (A) that will cause L0 to drop approximately 30 %
5. The part temperature (ambient + temp rise) should not exceed 125 °C under worst case operating conditions. Circuit design, component placement, PWB trace size and thickness, airflow and other cooling provisions all affect the part temperature. Part temperature should be verified in the end application.

#### Mechanical Reliability



400 1048 018  
+86 13338655578



www.wohu-tek.com  
wohu@wohu-tek.com



江苏省苏州市吴江区苏州湾  
阿尔法大厦A栋5F

Item	Specification and Requirement	Test Method
Solderability	1. No case deformation or change in appearance 2. New solder coverage More than 95%	1.Preheat: $155^{\circ}\text{C} \pm 5^{\circ}\text{C}$ , 60S $\pm$ 2S 2.Tin: lead-free. 3.Temperature: $240^{\circ}\text{C} \pm 5^{\circ}\text{C}$ , flux 3.0S $\pm$ 0.5S.
Mechanical shock	1. No case deformation or change in appearance 2. $\Delta L/L_0 \leq \pm 10\%$	1. Acceleration: 100G 2. Pulse time: 6ms 3. 3 times in each positive and negative direction of 3 mutual perpendicular directions
Mechanical vibration	1. No case deformation or change in appearance 2. $\Delta L/L_0 \leq \pm 10\%$	1. Reflow: 2times 2. Frequency: 10HZ $\sim$ 55HZ $\sim$ 10HZ, 20 Min/Cycles 3. Amplitude: 1.52 mm 4. Directions: X,Y,Z 5. Time: 12 cycle / direction
Endurance Reliability		
Item	Specification and Requirement	Test Method
Thermal Shock	Inductance change: Within $\pm 10\%$ Without distinct damage in appearance	1. First $-55^{\circ}\text{C}$ for 30 minutes, last $125^{\circ}\text{C}$ for 30 minutes as 1 cycle. Go through 1000 cycles. 2. Max transfer time is 3 minutes. 3. Measured at room temperature after placing for $24 \pm 2$ hours
Humidity Resistance	Inductance change: Within $\pm 10\%$ Without distinct damage in appearance	1.Reflow 2 times, 2. $85^{\circ}\text{C}$ ,85%RH,1000 hours 3.Measured at room temperature after placing for $24 \pm 2$ hours
Low temperature storage	Inductance change: Within $\pm 10\%$ Without distinct damage in appearance	1. Temperature: $-55 \pm 2^{\circ}\text{C}$ 2. Time: 1000 hours 3. Measured at room temperature after placing for $24 \pm 2$ hours
High temperature storage	Inductance change: Within $\pm 10\%$ Without distinct damage in appearance	1. Temperature: $+125 \pm 2^{\circ}\text{C}$ 2. Time: 1000 hours 3. Measured at room temperature after placing for $24 \pm 2$ hours



## Recommended Soldering Technologies

### (1)Re-flowing Profile

Preheat condition: 150 ~200℃/60~180sec.

Allowed time above 217℃: 80~120sec.

Max temp: 260℃

Max time at max temp: 10 sec.

Solder paste: Sn/3.0Ag/0.5Cu

Allowed Reflow time: 2x max

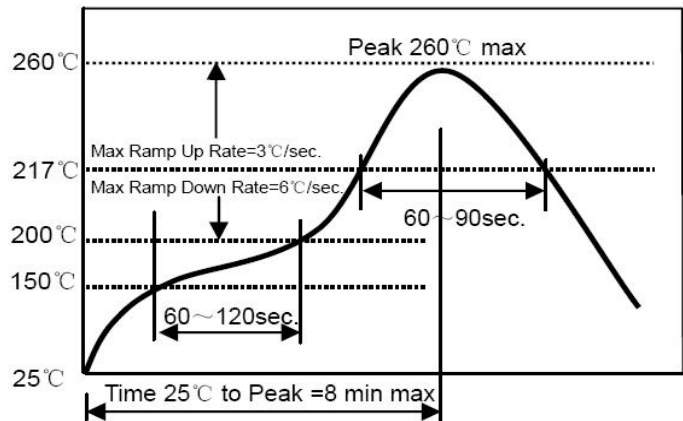

### (2)Iron Soldering Profile

Iron soldering power: Max. 30W

Pre-heating: 150℃/60sec.

Soldering Tip temperature: 350℃ Max.

Soldering time: 3sec. Max.

Solder paste: Sn/3.0Ag/0.5Cu

Max.1 times for iron soldering

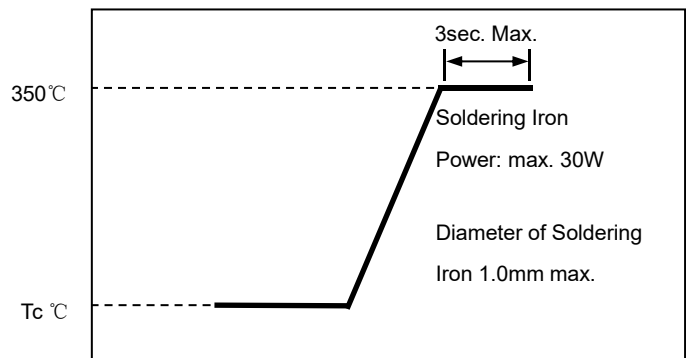

## Packaging Information

## (1) Tape Packaging Dimensions (Unit: mm)

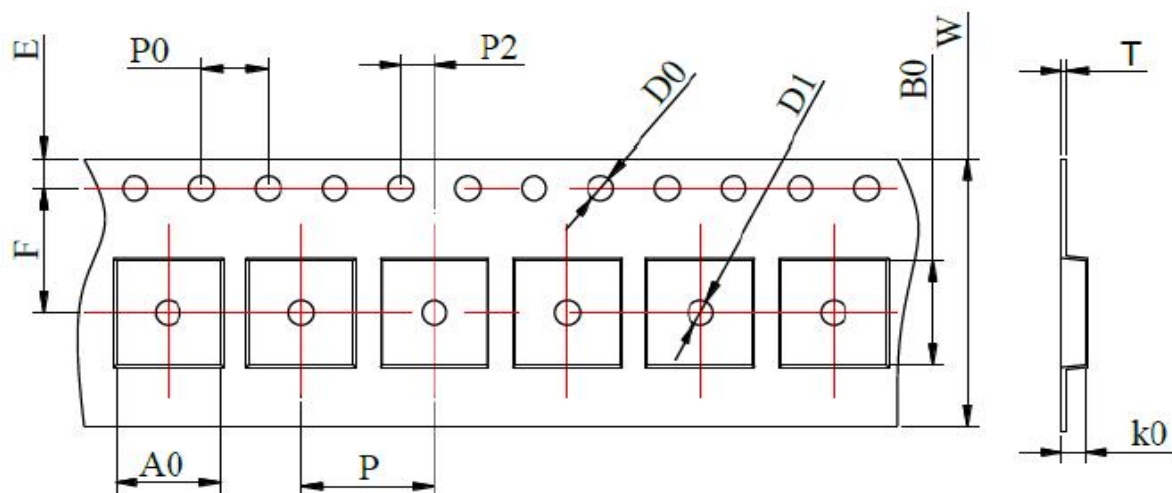

Type	Tape dimensions (mm)											
	W	P	P0	P2	D0	D1	T	A0	B0	K0	E	F
WHYT1050	24 ±0.3	16 ±0.1	4 ±0.1	2 ±0.05	1.5 ±0.1	1.5 ±0.1	0.4 ±0.05	10.4 ±0.1	11.6 ±0.1	5.4 ±0.1	1.75 ±0.1	11.5 ±0.1

## Taping Drawings (UNIT:mm)

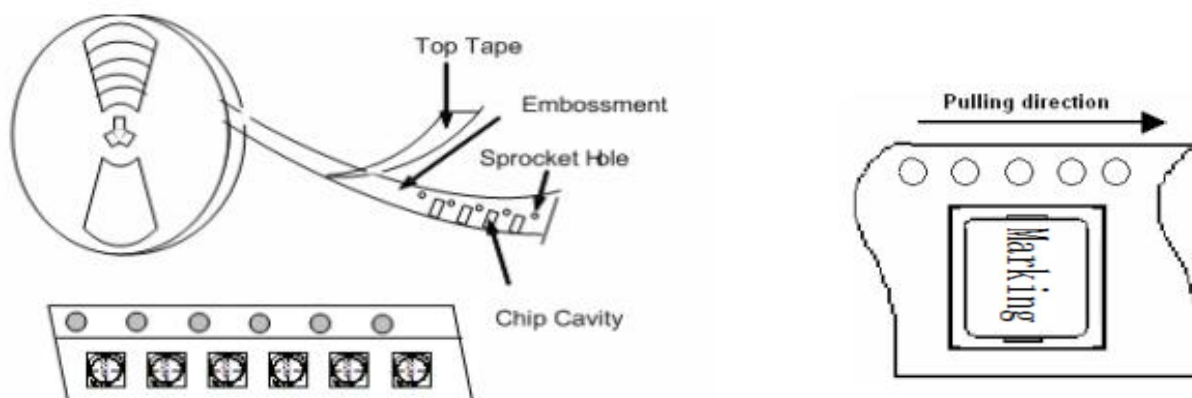

## (2) Reel Dimensions (Unit: mm)

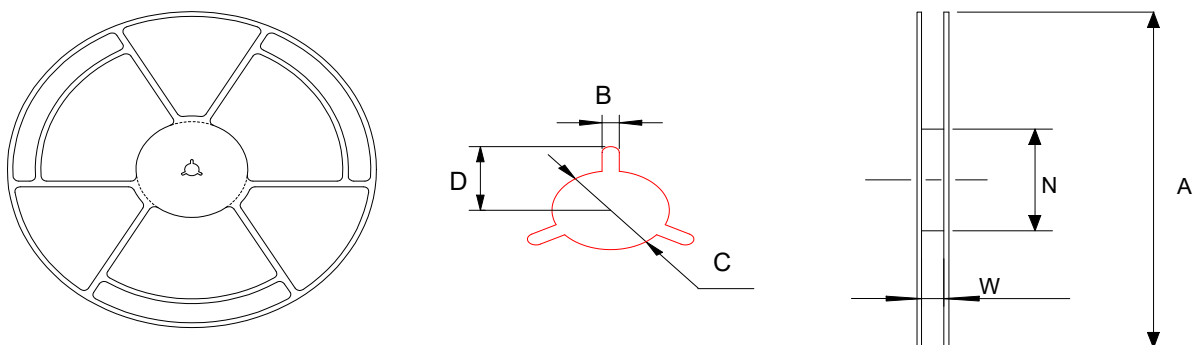

A	W	N	B	C	D
330±2.0	24±0.5	97±0.5	2.2±0.5	13.0±0.2	10.75±0.25

## (3) Packaging Quantity(PCS)

Type	Standard Quantity		
	Reel	Inner box	Carton box
WHYT1050	500 pcs / reel	2Reel / box (1000 pcs)	4 Middle boxes, (4000 pcs)

## (4) Peel force of top cover tape

The peel speed shall be about 300mm/minute

The peel force of top cover tape shall be between 0.1 to 1.3 N

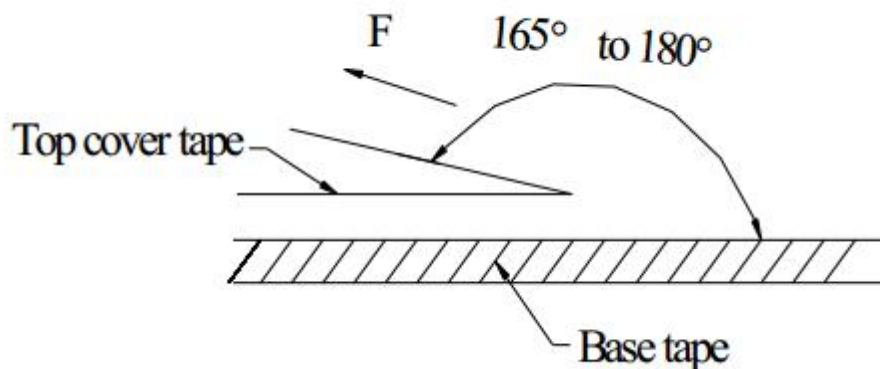

## (5) Reel Label



400 1048 018  
+86 13338655578



www.wohu-tek.com  
wohu@wohu-tek.com



江苏省苏州市吴江区苏州湾  
阿尔法大厦A栋5F

## Label on the reel

- Customer's part Number
- Lot Number
- Quantity
- date code

## Shipping Label

- Customer's part Number
- Manufacturer's part Number
- Quantity
- date code

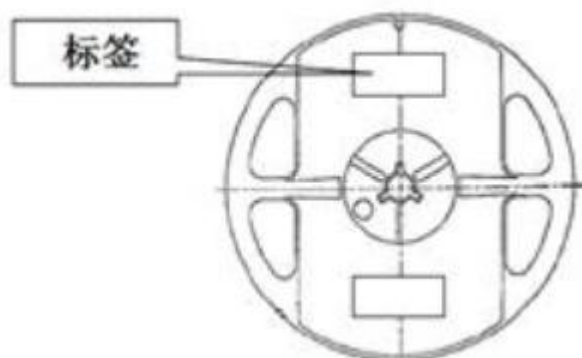

## (6) Inner Box

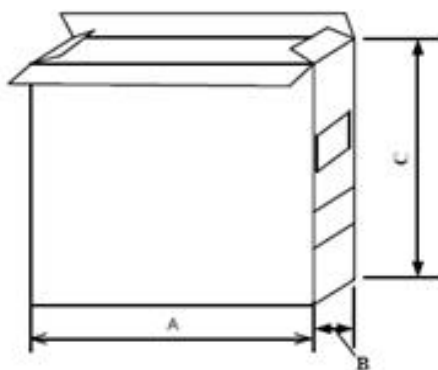

Packaging type	A (mm)	B (mm)	C (mm)
Inner box	335	70	340

## (7) Carton

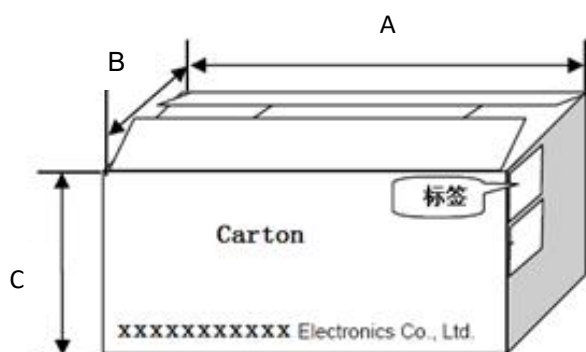

Packaging type	A (mm)	B (mm)	C (mm)
type	360	360	360

